



10 Beehive Close

Cholsey, OX10 9BF

50% Shared Ownership £150,000

Beautiful two-bedroom first-floor apartment situated in the charming village of Cholsey, renowned for its picturesque countryside and strong sense of community. This lovely home features a bright and spacious interior, complemented by a stylish Juliet balcony that allows for plenty of natural light to fill the living space.

The property offers two comfortable bedrooms, a modern bathroom, and an open-plan living and dining area that seamlessly connects to the balcony—perfect for relaxing. The well-designed kitchen is equipped with contemporary appliances. The property also benefits from two allocated parking spaces and gas central heating.

Located in the desirable village of Cholsey, residents benefit from a range of local amenities including shops, pubs, and cafes. The village is well-connected, with a railway station providing direct services to Oxford, Reading, and London, making it an ideal location for commuters. Surrounded by stunning countryside and scenic walking trails, Cholsey offers a peaceful yet vibrant lifestyle with easy access to outdoor activities and regional attractions.

- Full Market Price £300,000
- Shares Available 50% - 100%
- Current Monthly Rent £222.56
- Current Monthly Service Charge £45.03
- Lease Term Remaining 79
- Two Double Bedrooms First Floor Apartment
- Bright Living Room with Juliette Balcony
- Well Designed Kitchen
- Perfectly Appointed Bathroom
- Two Allocated Parking Spaces



Floor Plan

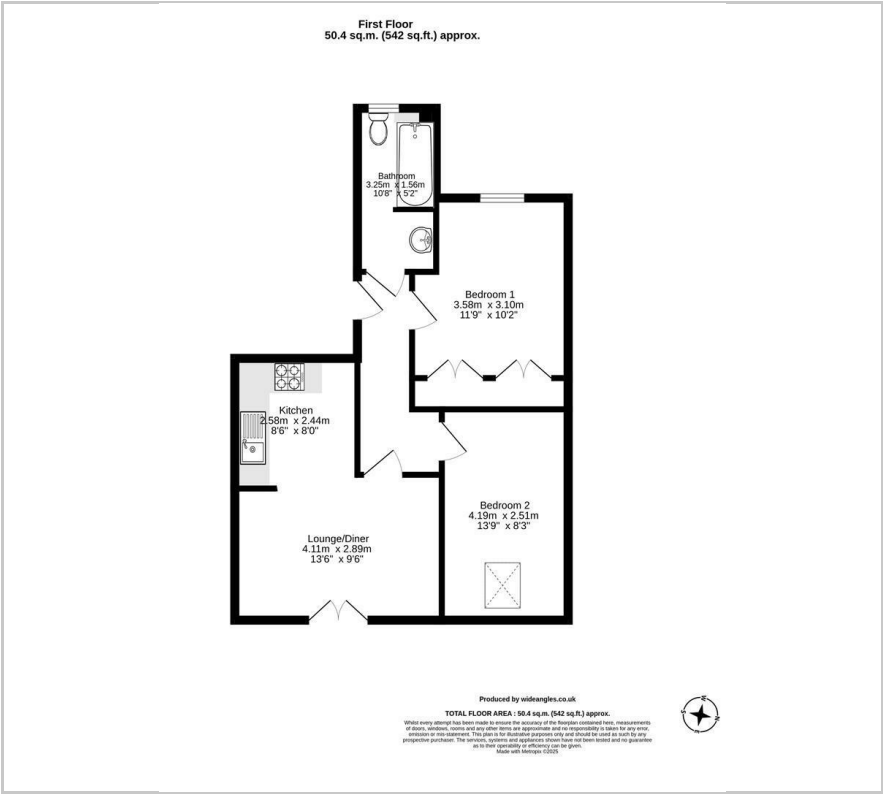

Area Map



Energy Efficiency Graph

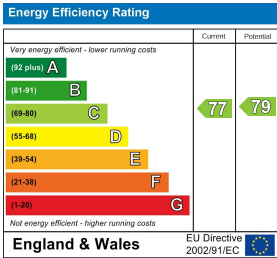

These particulars, whilst believed to be accurate are set out as a general outline only for guidance and do not constitute any part of an offer or contract. Intending purchasers should not rely on them as statements of representation of fact, but must satisfy themselves by inspection or otherwise as to their accuracy. No person in this firm's employment has the authority to make or give any representation or warranty in respect of the property.